



Appearance		
Sensing type	Diffuse reflection	
Sensing range	250~3500mm	350~6000mm
Resolution	4mm	6mm
Repeat accuracy	1%	0.5%
Hysteresis	1%	
Linearity error	1%	
Opening angle	±7°	±9°
Switch frequency	2Hz	1Hz
Response time	Switch:250ms, analog:600ms	Switch:500ms, analog:600ms
Operating voltage	12~30VDC , Analog voltage output: 15~30VDC(±5%)	
Temperature compensation	Yes	
Temperature drift	±8% ( switch output ) , ±5% ( analog output )	
Voltage drop	2.2V max.(1L=100mA)	
Current consumption	≤50mA	
Max. load current	100mA	
Min. load resistance	3k Ω	
Leakage current	≤10 μA@30V DC	
Sensitivity adjustment	Teach-in	
Operating temperature	-20°C~+70°C	
Storage temperature	-35°C~+70°C(No freezing)	
Circuit protection	Reverse polarity protection,Short circuit (auto reset),Over voltage pulses protection	
Degree of protection	IP67	
Housing material	PBT	
Sensing surface material	Epoxy-glass resin	
Weight	140g	170g
Analog output	Voltage	<b>MC30-350V</b>
	Current	<b>MC30-350I</b>
Switch output	NPN	<b>MC30-350N</b>
	PNP	<b>MC30-350P</b>
Dual switch output	NPN	<b>MC30-350N2</b>
	PNP	<b>MC30-350P2</b>
Analog+Switch	NPN+Current	<b>MC30-350NI</b>
	PNP+Current	<b>MC30-350PI</b>
	NPN+Voltage	<b>MC30-350NV</b>
	PNP+Voltage	<b>MC30-350PV</b>
		<b>MC30-600N2</b>
		<b>MC30-600P2</b>
		<b>MC30-600NI</b>
		<b>MC30-600PI</b>
		<b>MC30-600NV</b>
		<b>MC30-600PV</b>

- Fiber Optic
- Slot Sensors
- Photoelectric
- Laser
- Proximity
- Displacement
- Magnetic
- Contact
- Area
- Ultrasonic
- Vision
- Code Readers
- Vibration
- Temperature
- Accessories

- Guidance**
- Ultrasonic
  - Cylindrical type
  - Solid liquid level switches type
  - Fork type liquid level switch type
  - Double-sheet detection sensor

### Dimensions

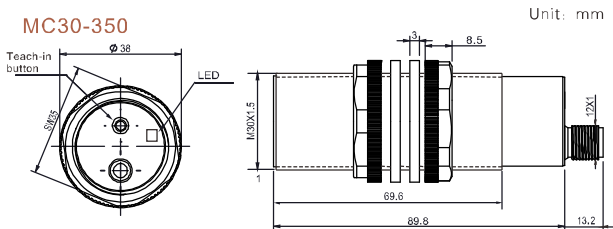

### MC30-600

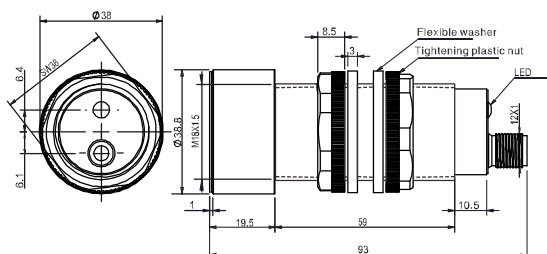

### Wiring Diagram

