

- Fiber Optic
- Slot Sensors
- Photoelectric**
- Laser
- Proximity
- Displacement
- Magnetic
- Contact
- Area
- Ultrasonic
- Vision
- Vibration
- Temperature
- Annexes

Guidance

Photoelectric

- Cylindrical
- Square
- Flat type
- Thin type
- BGS
- Transparent detection
- Color/Mark Detection
- TOF reflective
- IP69K high protection type
- Anti-glare type

Reflectors

Reflectors

STD-06

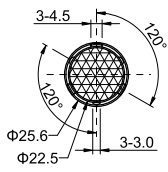

Thickness: 8mm

TD-04

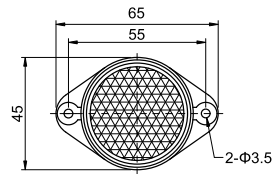

Thickness: 8mm

TD-05

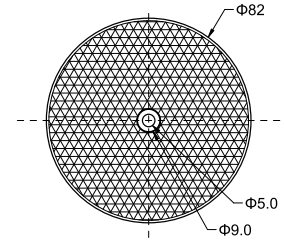

Thickness: 8mm

TD-09

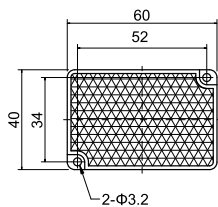

Thickness: 8mm

TD-02

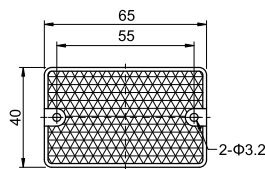

Thickness: 8mm

TD-08

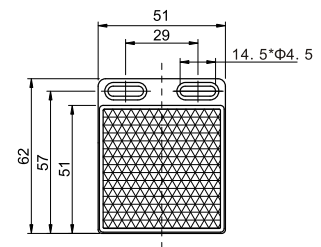

Thickness: 8mm

TD-01

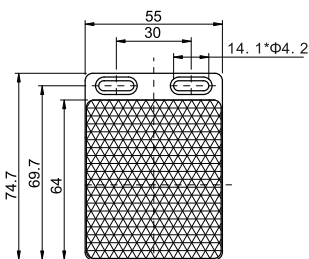

Thickness: 8mm

TD-03

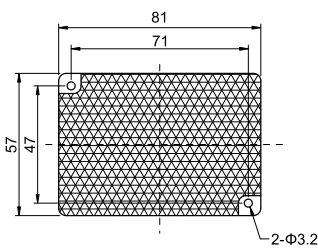

Thickness: 8mm

TD-01-3

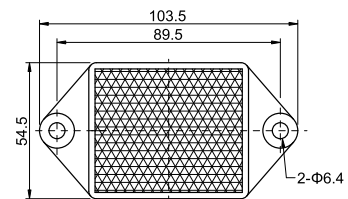

Thickness: 8mm

TD-10

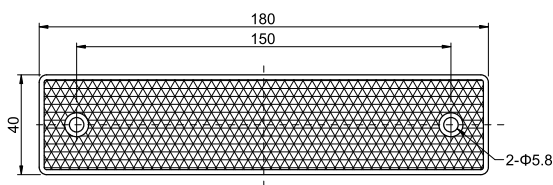

Thickness: 8mm

Reflectors

Dimensions

Unit: mm

TD-11

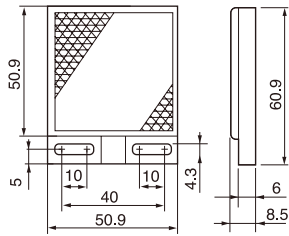

TD-12

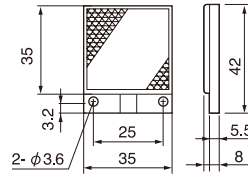

TD-13

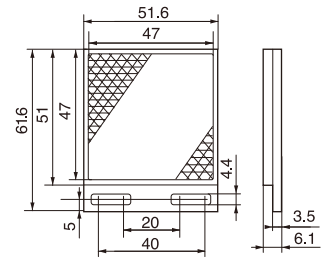

TD-14

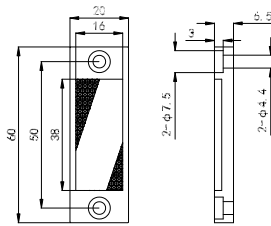

TD-15

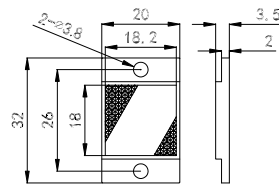

TD-22

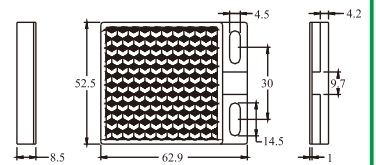

Guidance

Photoelectric

Cylindrical

Square

Flat type

Thin type

BGS

Transparent detection

Color/Mark Detection

TOF reflective

IP69K high protection type

Anti-glare type

Reflectors

Reflectors